

# Soils Map

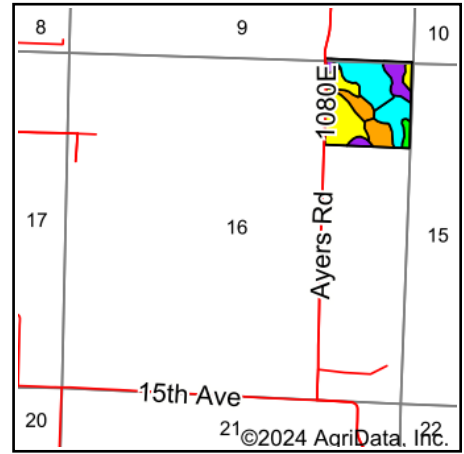

State: **Illinois**  
 County: **Bond**  
 Location: **16-6N-3W**  
 Township: **Lagrange**  
 Acres: **40.85**  
 Date: **10/16/2024**

Maps Provided By:  
  
 CUSTOMIZED ONLINE MAPPING  
 © AgriData, Inc. 2023 www.AgriDataInc.com

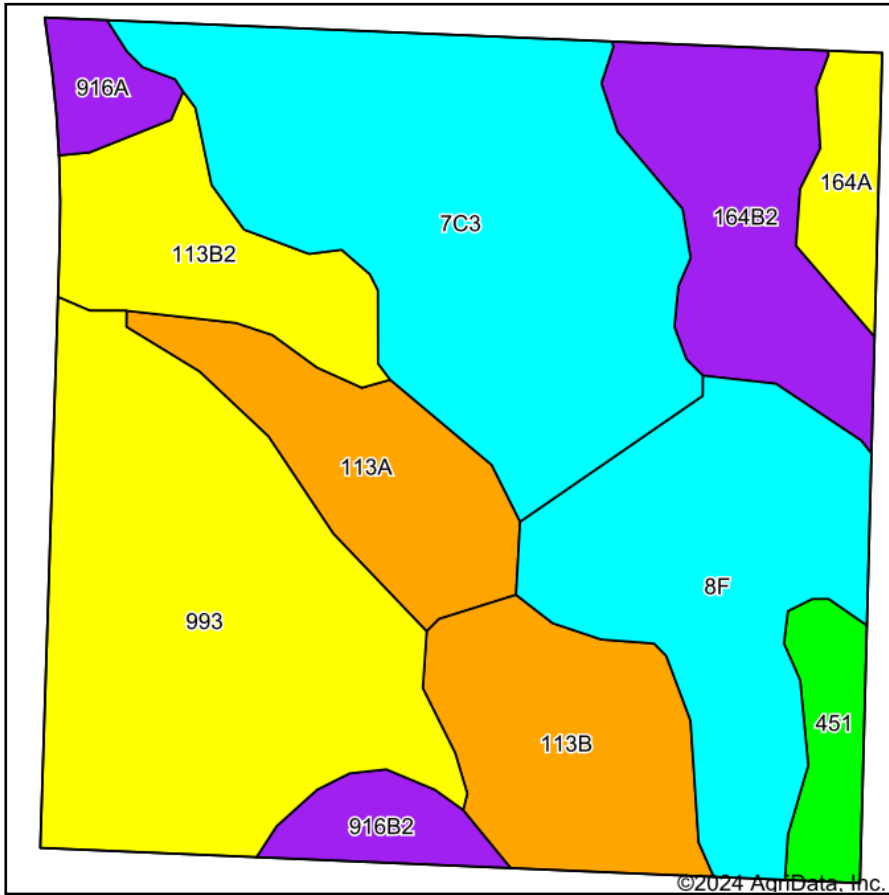

Soils data provided by USDA and NRCS.

Area Symbol: IL005, Soil Area Version: 19

Code	Soil Description	Acres	Percent of field	Il. State Productivity Index Legend	Subsoil rooting a	Corn Bu/A	Soybeans Bu/A	Wheat Bu/A	Oats Bu/A b	Sorghum c Bu/A	Grass-le gume e hay, T/A	Crop productivity index for optimum management	*n NCCPI Soybeans
**7C3	Atlas silty clay loam, 5 to 10 percent slopes, severely eroded	9.51	23.3%		UNF	**86	**30	**34	**39	0	**2.60	**66	41
993	Cowden-Piasa silt loams	9.06	22.2%		FAV	148	49	58	33	60	4.50	111	54
**8F	Hickory silt loam, 18 to 35 percent slopes	5.69	13.9%		FAV	**89	**30	**36	**41	0	**3.00	**68	14
**164B2	Stoy silt loam, 2 to 5 percent slopes, eroded	3.61	8.8%		FAV	**136	**44	**55	0	**106	**4.30	**102	58
**113B	Oconee silt loam, 2 to 5 percent slopes	3.52	8.6%		FAV	**162	**50	**62	0	**118	**5.20	**118	65
113A	Oconee silt loam, 0 to 2 percent slopes	2.94	7.2%		FAV	164	50	63	0	119	5.30	119	66

Soils data provided by USDA and NRCS. Soils data provided by University of Illinois at Champaign-Urbana.



Code	Soil Description	Acres	Percent of field	Il. State Productivity Index Legend	Subsoil rooting <b>a</b>	Corn Bu/A	Soybeans Bu/A	Wheat Bu/A	Oats Bu/A <b>b</b>	Sorghum <b>c</b> Bu/A	Grass-legume <b>e</b> hay, T/A	Crop productivity index for optimum management	*n NCCPI Soybeans
**113B2	Oconee silt loam, 2 to 5 percent slopes, eroded	2.72	6.7%		FAV	**154	**47	**59	0	**112	**5.00	**112	55
451	Lawson silt loam, cool mesic, 0 to 2 percent slopes, occasionally flooded	1.12	2.7%		FAV	190	61	73	97	0	5.80	140	86
164A	Stoy silt loam, 0 to 2 percent slopes	1.01	2.5%		FAV	145	47	58	0	113	4.60	109	69
**916B2	Oconee-Darmstadt silt loams, 2 to 5 percent slopes, eroded	0.93	2.3%		FAV	**132	**44	**50	0	**102	**4.00	**99	47
916A	Oconee-Darmstadt silt loams, 0 to 2 percent slopes	0.74	1.8%		FAV	141	47	54	0	109	4.50	106	61
<b>Weighted Average</b>						<b>127.6</b>	<b>41.6</b>	<b>50</b>	<b>24.8</b>	<b>56</b>	<b>4</b>	<b>95.4</b>	<b>*n 48.8</b>

**Table: Optimum Crop Productivity Ratings for Illinois Soil EFOTG are sourced from Bulletin 811 calculated Map Unit Base Yield Indices, and adjusted (Adj) for slope, erosion, flooding, and surface texture.** Publication Date: 02-08-2023

Crop yields and productivity (B811 EFOTG) are maintained at the following USDA web site: 2023 Illinois Soil Productivity and Yield Indices: <https://efotg.sc.egov.usda.gov/#/state/IL/documents/section=2&folder=52809>

\*\* Base indexes from Bulletin 811 adjusted for slope, erosion, flooding, and surface texture according to the Il. Soils EFOTG

**b** Soils in the southern region were not rated for oats and are shown with a zero "0".

**c** Soils in the northern region or in both regions were not rated for grain sorghum and are shown with a zero "0".

**e** Soils in the well drained group were not rated for grass-legume and are shown with a zero "0".

\*n: The aggregation method is "Weighted Average using all components"