

ONLINE ONLY RESIDENTIAL REAL ESTATE AUCTION

TBB 0.48+/- Acres, Washington Place, Edwardsville, IL 62025



618-234-8751
Adam Jokisch
Mobile (618) 530-8751

BIDDING CLOSES: 6PM ~ TUESDAY, DECEMBER 17, 2024

For Online Bidding Visit: AdamsAuctions.HiBid.com

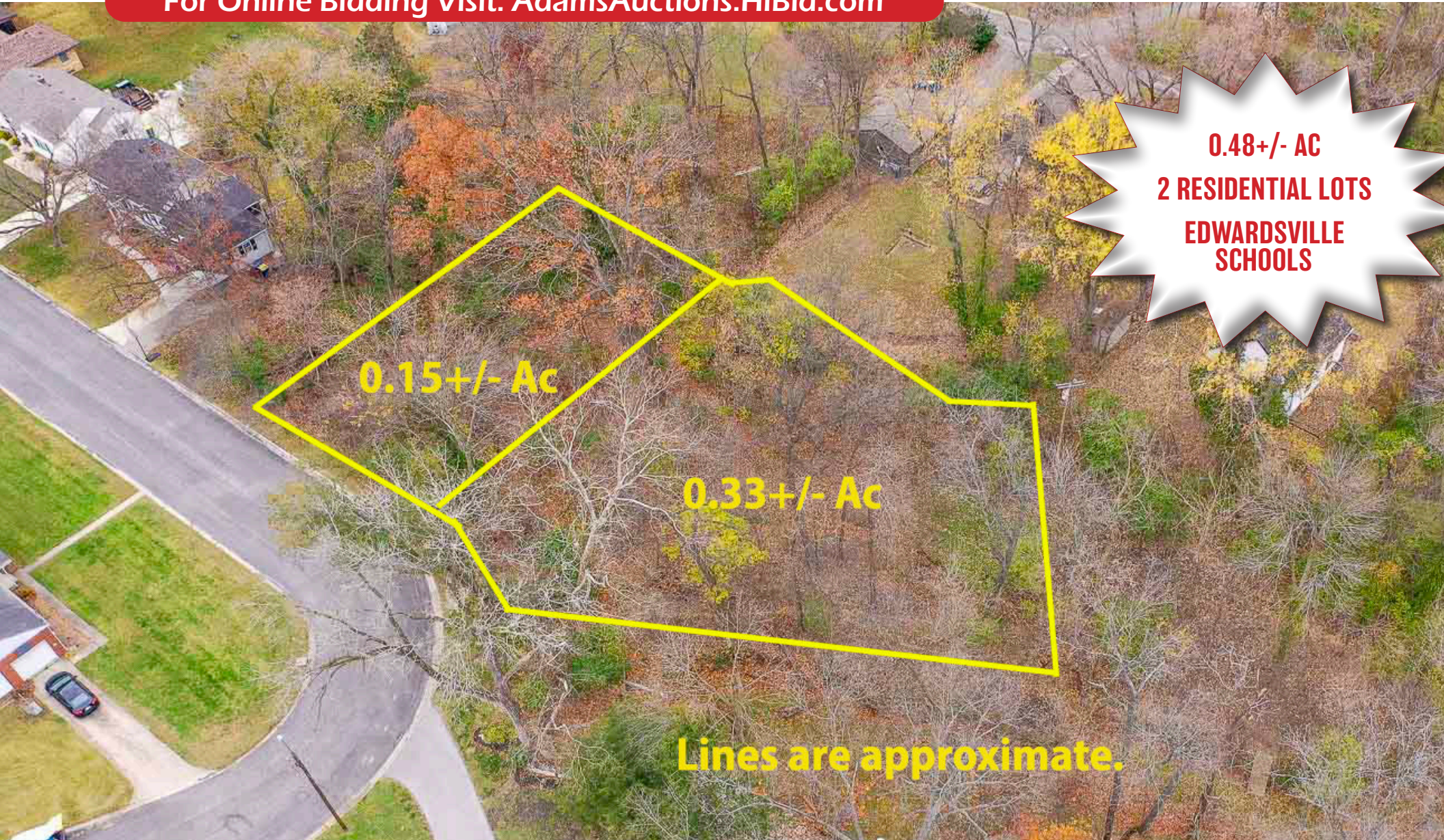

**0.48+/- AC
2 RESIDENTIAL LOTS
EDWARDSVILLE
SCHOOLS**

Lines are approximate.

GENERAL INFORMATION & AUCTION TERMS



0.48+/- AC
TOTAL LOT SIZE

R1 - SINGLE FAMILY
ZONING

\$1,178
TOTAL '23 TAXES

Great opportunity to acquire this spacious 0.48+/- ac parcel located directly off Washington Place in the Lake View Terrace Neighborhood of the charming city of Edwardsville, IL! The property is Zoned R1-Single Family and lies within the City of Edwardsville Zoning Jurisdiction. This gently rolling to sloping property has had the water, sewer and gas installed on the property and has electric utilities available to be brought onsite by the new owner. These two parcels selling as one are centrally located near Schools, shopping and restaurants with all Metro East Thoroughfares easily accessible!

PARCEL NUMBERS

P.I.N	Size	Amount
14-2-15-13-05-102-013	0.15± Ac.	\$526
14-2-15-13-05-102-014	0.33± Ac.	\$652

Terms: \$1,000 Down Day of Sale on Real Estate
Balance Due in 30 Days ♦ 10% Buyers Premium or \$1000 Minimum
List subject to change without notice
Final Bid is Subject to Owner/Seller Approval. LIC# 044000169
Any announcement made day of sale takes precedence over any printed material



Text ADAMS to 1-800-496-6299 To Be Notified of ALL of our Upcoming Auctions

Enclosed information was obtained from sources considered reliable. However, the auction company does not guarantee the accuracy of this information. Said information is subject to change availability or update without notice. Seller/Landlord & Auction Company make no representation as to the environmental condition of the property and recommend that Purchaser/Tenant obtain an independent investigation. Final bid is subject to Owner/Seller approval.